

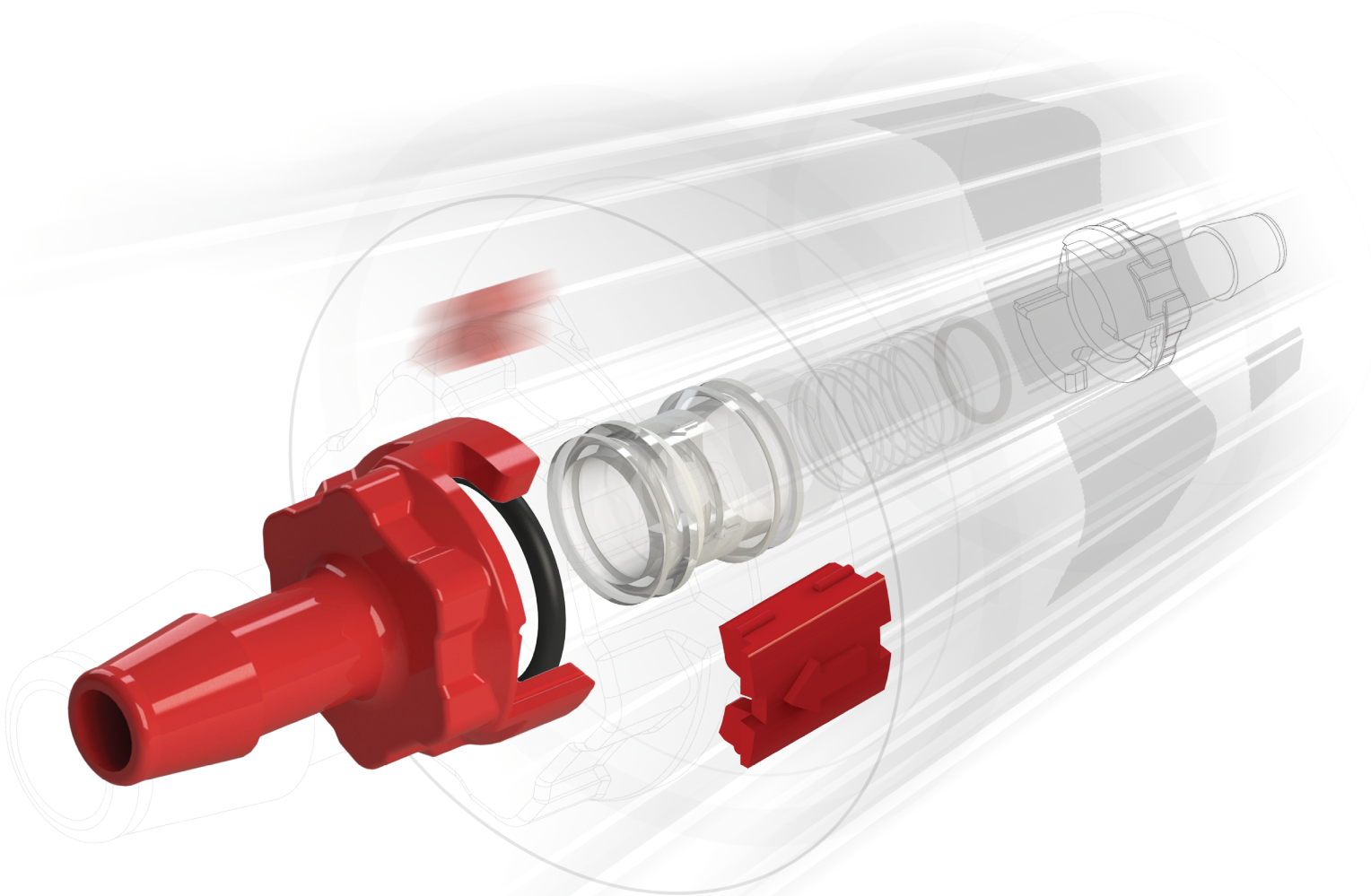

Your gateway to a world  

---

of miniature fluid control



# Modular Check Valves

A check valve ensures single directional flow of either liquid or gas.

Our modular Check Valve with internal O-ring sealing utilises a spring forced floating poppet to allow flow at pre-defined cracking pressures.

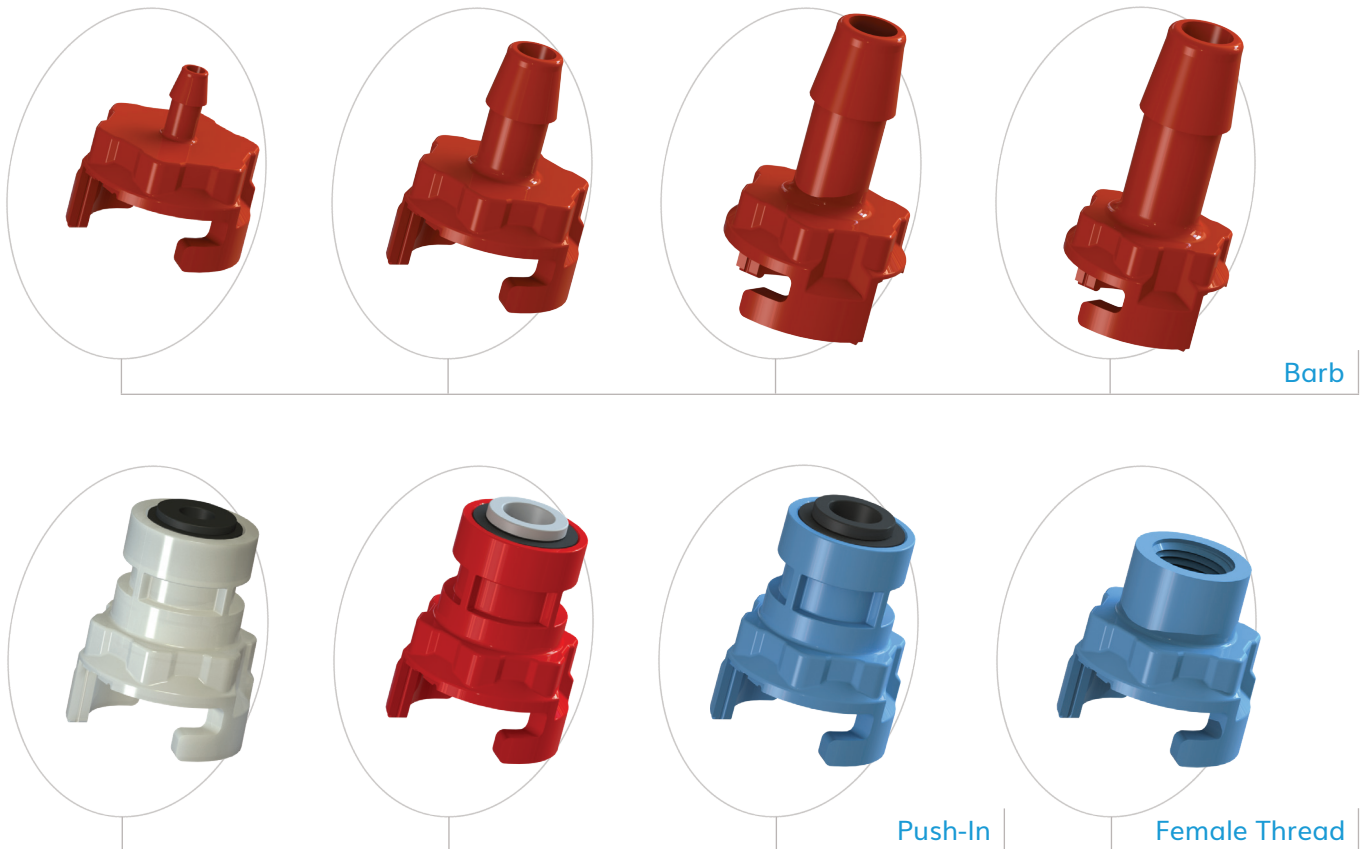

#### Key features of our check valve range:

- ✓ Modular assembly allows multiple combinations
- ✓ Single barb design to improve seal and improve clamping
- ✓ Unique push-in range
- ✓ Female thread form options for 1/8" NPT, BSPT and BSPP fittings
- ✓ Locking clips to prevent accidental disassembly
- ✓ Easy to use cartridge for manifold assembly
- ✓ Mixed imperial and metric combinations
- ✓ Easy to take apart for R&D purposes (build your own kits available)
- ✓ Multiple spring options

Get in touch and we will be delighted to work with you and discuss your exact check valve requirements.

# Full Technical Specification

Our Solidworks certified engineers provide full technical data for every product, downloadable dimensional drawings and 3D CAD models to ensure accurate product selection. Visit [eoxshop.com](http://eoxshop.com) for full details.

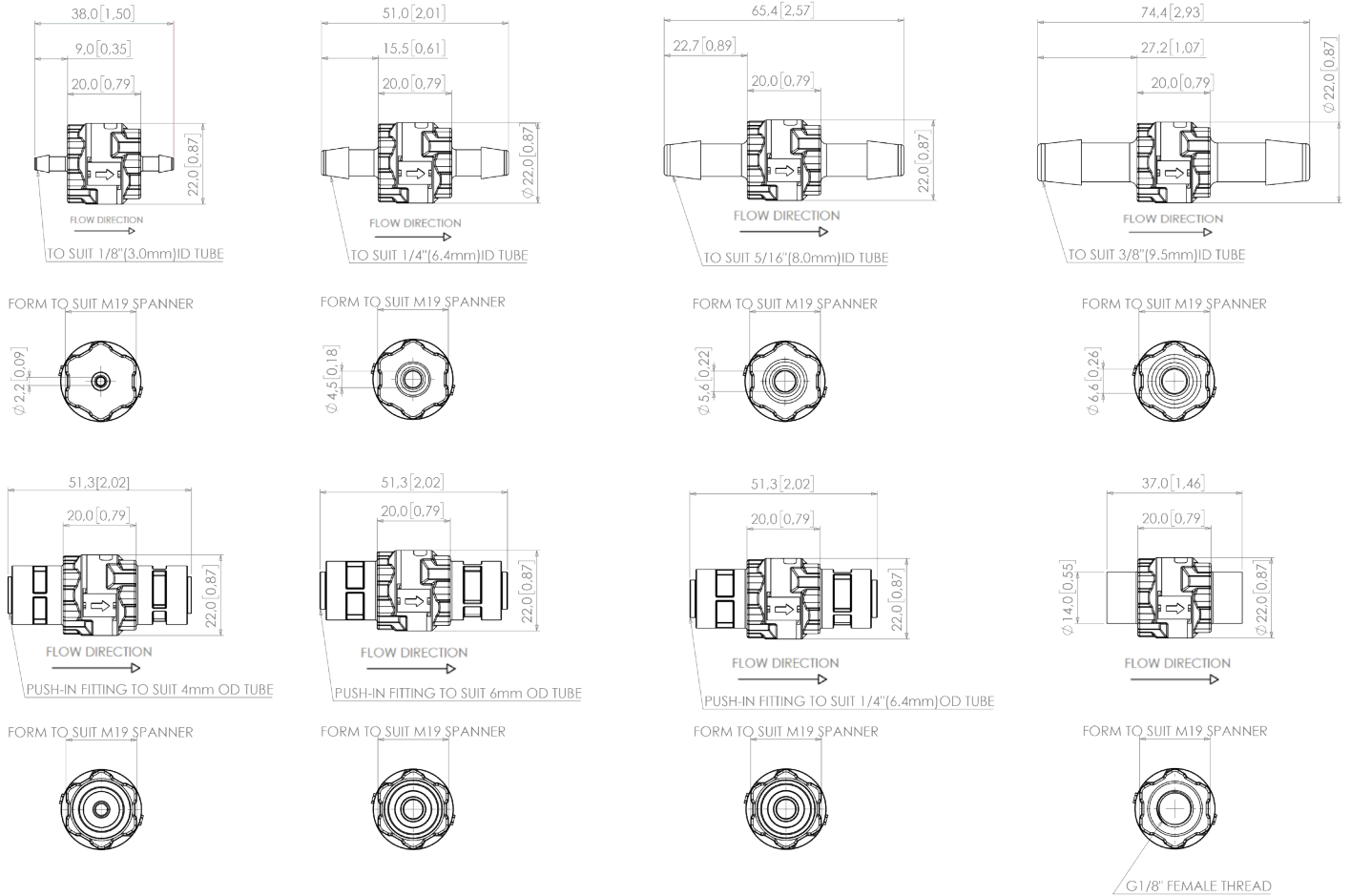

## Technical Specification

<b>Case Material:</b>	Glass Filled Polypropylene (FDA CFR21 approved)
<b>Valve Cartridge Material:</b>	Polypropylene (FDA CFR21 approved)
<b>Poppet Material:</b>	Polypropylene (FDA CFR21 approved)
<b>Spring Material:</b>	Stainless Steel 302
<b>O-ring material options:</b>	Nitrile, EPDM, Silicone, Viton
<b>Max. Inlet Pressure:</b>	100 psi (6.9 bar) @ ambient 21°C (70°F)
<b>Style:</b>	In-line
<b>Operating Temperature:</b>	5°C (41°F) to 50°C (122°F)
<b>Recommended Media:</b>	Gas or Liquid (customer to test for compatibility)
<b>Weight:</b>	5.3g (0.095oz) (1/8" barb assembly)
<b>Storage Temperature:</b>	-50°C (-58°F) to 50°C (122°F)
<b>Cycling:</b>	Min 100,000 cycles – Maintenance free
<b>Approvals:</b>	FDA CFR21 / RoHs / REACH



# Check Valve Assembly Configurator

Our check valve range is extensive. With our new online Check Valve Assembly Configurator, you can build the valve specification your application requires.

Available in spring 2019, you will be able to select your preferred option from the drop-down menu to build the product specification you require.

Example Product Code: **E-C58-PG-2NB1GR-N3** (see table below)

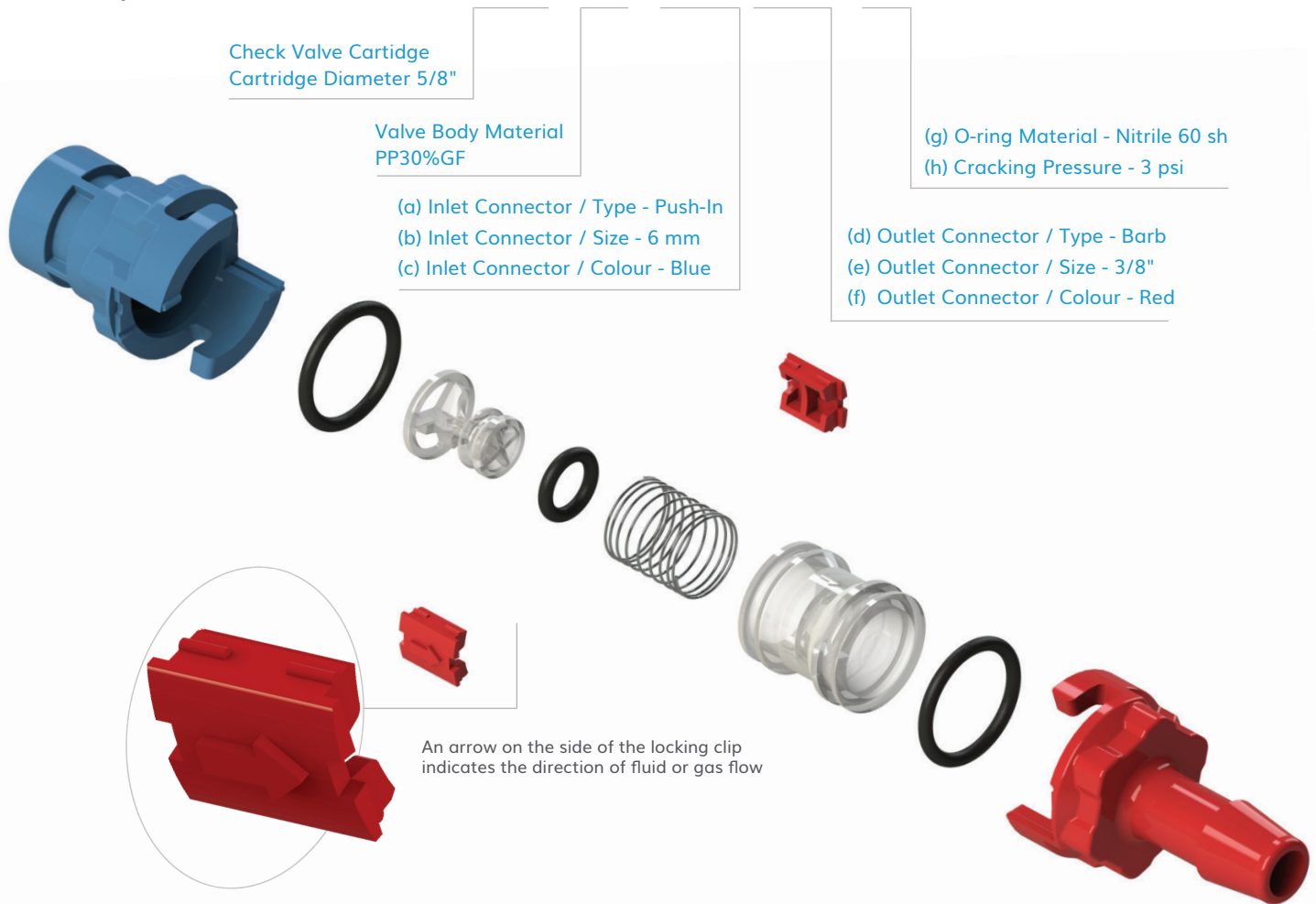

Inlet Connector			Outlet Connector			O-ring Material (g)	Cracking Pressure (h)
Type (a)	Size (b)	Colour (c)	Type (d)	Size (e)	Colour (f)		
1 = Barb	C = 1/8" E = 1/4" F = 5/16" G = 3/8"	R = Red N = Natural B = Blue	1 = Barb	C = 1/8" E = 1/4" F = 5/16" G = 3/8"	R = Red N = Natural B = Blue	N = Nitrile 60 sh E = EPDM 70 sh S = Silicone 70 sh V = FKM Viton 75 sh	0.1 = 0.1 psi 0.5 = 0.5 psi
2 = Push-In	M = 4 mm N = 6 mm E = 1/4"		2 = Push-In	M = 4 mm N = 6 mm E = 1/4"			1 = 1 psi 2 = 2 psi 3 = 3 psi 4 = 4 psi
3 = BSPP Female Thread	C = 1/8"		3 = BSPP Female Thread	C = 1/8"			5 = 5 psi 10 = 10 psi

Online configurator available Spring 2019